

ANY
APPLIANCE
EVERY
HEATING SYSTEM
ONE
VENTING SOURCE



Z-FLEX®

No matter what the venting application,
from gas fired to oil to all fuel heating equipment,
Z-FLEX is your one-stop solution.

Specialists in Flexible

Z-FLEX has been providing flexible answers to gas, oil, pellet and wood venting applications since 1979. We have pioneered flexible chimney liner solutions and special gas vent (AL29-4C®).

A variety of innovations in materials and construction have led to products that deliver:

- Superior performance and increased efficiency
- Easier handling and faster, simpler installation
- Greater reliability, safety and increased service life

To that we add responsive customer service along with expert technical support.

Z-FLEX is the leading manufacturer of specialty venting systems for furnaces, boilers, water heaters, oil heaters, fireplaces, and more.

Advanced products for maximum performance

- Patented Triple-Lock Design for Strength
- Compressed to Lower Shipping Costs
- Best Available Materials/Alloys
- 20+ Years of Manufacturing Experience
- "Immediate" Availability (24-72 Hr. Lead Time)
- Listed by Underwriters Laboratories 



Venting Solutions

Safety Issues

Since the federal government required modern heating equipment to achieve higher efficiencies in 1992, safely venting them has become more of a challenge. Today's more efficient equipment produces lower flue gas temperatures than pre-1992 equipment. The low temperature flue gas provides little natural draft in chimneys and is more likely to condense into an acidic, and corrosive, solution. The result can cause property damage, personal injury, or death. The natural laws of physics that control this phenomenon pertain to all gas and oil fired equipment.

Our three major product lines; chimney liners, special gas vent (AL29-4C® stainless steel), and flexible vent connectors are all designed to **prevent** flue gas condensation or **protect** against its corrosive effects. Most of the products Z-FLEX has developed are now recommended or required by the following national codes and testing agencies:

1992 National Fuel Gas Code

- Venting Tables for sizing Chimney Liners and Vent Connectors when adding or replacing equipment
- Insulated Connectors required in attics and other "cold" spaces

1997 NFPA 31 "Installation of Oil Burning Equipment"

- Venting Tables for sizing Chimney Liners

International Approval Services (formerly AGA)

- June, 1996 – IAS requires all Category III gas boilers and furnaces to use a UL 1738 approved vent system (like our Z-Vent)
- July, 1998 – IAS requires all Category III gas residential unit heaters to use a UL 1738 approved vent system (like our Z-Vent)

HEAT DISTRIBUTION

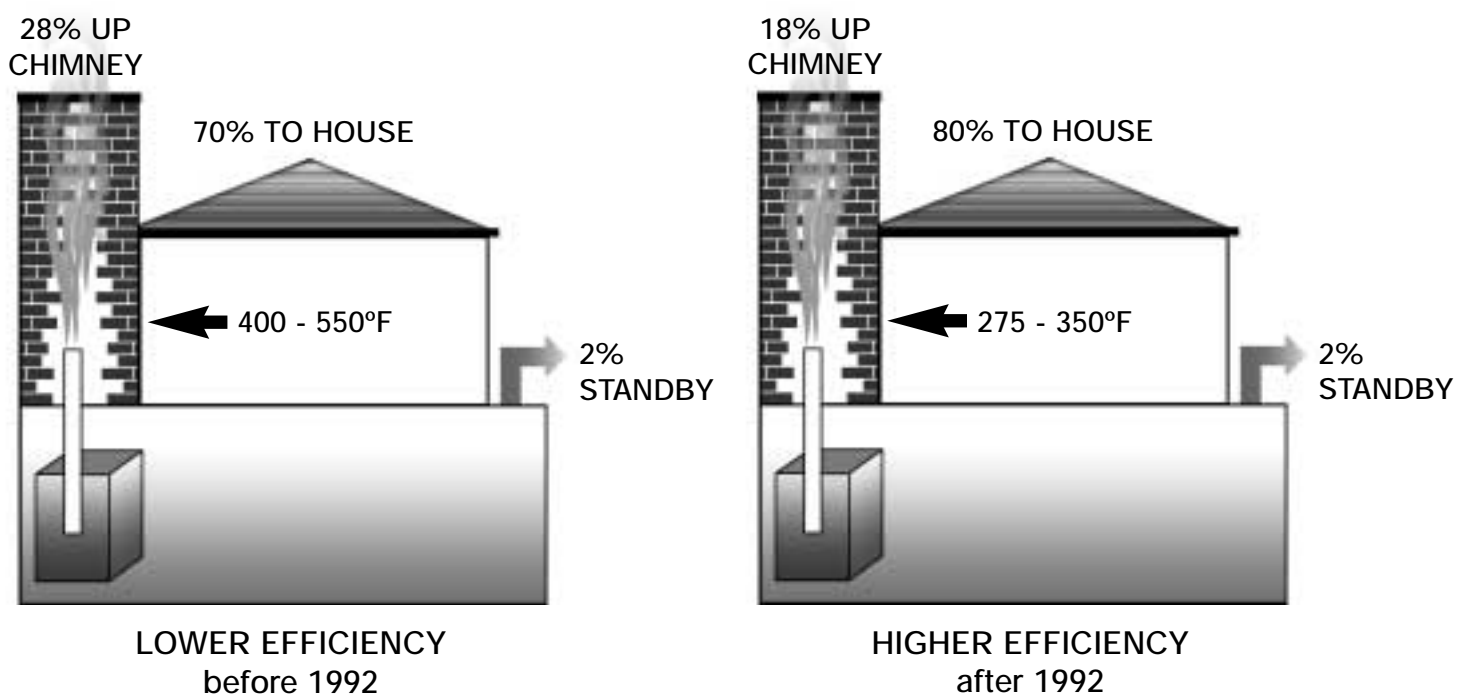

- Higher Efficiency Produces Lower Stack Temperatures

Aluminum Chimney

Gas Kit

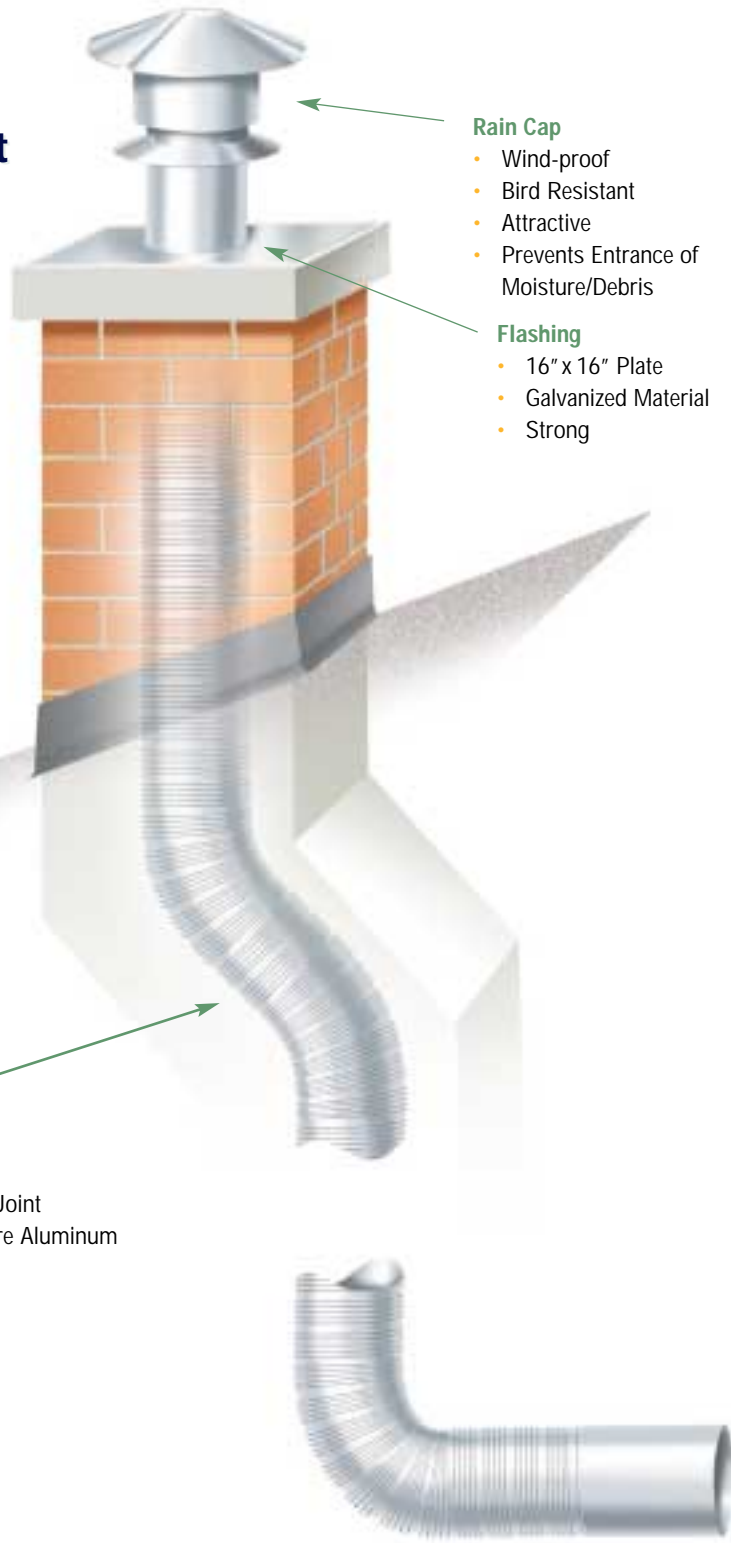

Rain Cap

- Wind-proof
- Bird Resistant
- Attractive
- Prevents Entrance of Moisture/Debris

Flashing

- 16" x 16" Plate
- Galvanized Material
- Strong

Fireplace Connector

- Gas Fireplace Kits only



Mortar Collar

- Simple to Install
- Clean Look
- Corrosion-resistant Material

Flexible Aluminum Liner

Special Characteristics

- Patented Triple-Lock Mechanical Joint
- Manufactured from Dead Soft Pure Aluminum



Significant Advantages

- Greater Flexibility
- Exceptional Strength
- Corrosion Resistant
- Air-tight and Leakproof
- Vibration Deadening Properties
- Light Weight
- Highly Puncture Resistant
- High Pressure Rating

Z-FLEX CHIMNEY LINERS ARE LISTED WITH UNDERWRITERS LABORATORIES, FILE MH 13681

Liner Kits

Z-FLEX Aluminum Chimney Liner Kits come complete with everything you need to quickly and easily install a professional venting system.

Z-FLEX liner is manufactured by using a dead soft aluminum strip which is spirally wound and MECHANICALLY joined together forming an air-tight and leakproof TRIPLE-LOCK seam.

Z-FLEX's specially designed 'deep corrugations' provide for greater flexibility and ease of installation. The result is a clearly superior product offering incredible longevity.

When to Z-FLEX a Chimney (FROM NATIONAL GAS CODE)

- When a masonry chimney has no liner at all
- When damage to existing chimney lining is evident
- When retrofit appliance has fan-assisted combustion and is vented alone
- When additional or replacement equipment is installed or an appliance is converted to gas from another fuel
- When the existing chimney is oversized relative to heating requirement

**10 YEAR
LIMITED
WARRANTY**



Aluminum Liner Kit

Kit Includes:

- 2-Ply Aluminum Liner
- Chimney Flashing
- Rain Cap
- Mortar Collar
- 3 Screws

Part # 2GACKIT ___Dia. ___Lgth.
Available in 3" - 10" Diameters
15' - 50' Lengths.



Gas Fireplace Kit

Kit Includes:

- 2-Ply Aluminum Liner
- Chimney Flashing
- Rain Cap
- Fireplace Adapter (Single Appliance)
- 3 Screws

Part # 2GAFKKIT ___Dia. ___Lgth.
Available in 3" - 10" Diameters
15' - 50' Lengths.

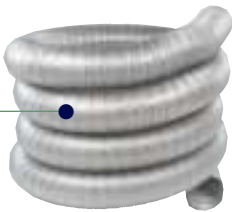

Additional Length Aluminum 2-Ply Liner

Part # 2GAXXXX ___Dia. ___Lgth.
Available in multiples of 5'.



Liner Coupling

Part # 2CNNTRG ___Dia.
Available in 3" - 10" diameters
Custom sizes available.
Used to attach two lengths
of pipe.



B-Vent Connector

Part # 2CNNBFC ___Dia.
Available in 3" - 10" diameters
Connects B-Vent to Z-FLEX liner.



Galvanized "Y"

Part # 2WYEGAL ___Dia.
Available in: 3" to 8" Diameters.
Connects two vent connectors
to common vent.



Nose Cone

Part # 2NCXXX ___Dia.
Available in 3", 4", 5", 6",
7", 8", 10" Diameters.

Z-FLEX Insul-Liner™

Pre-insulated Chimney Liner for Category I Gas Heating Equipment & Gas Fireplaces

Insul-Liner is another "simple solution" from Z-FLEX. The National Fuel Gas Code (NFPA 54, ANSI Z223.1) recommends, but does not require, that liners be insulated in certain situations.

A good rule of thumb is to use an insulated liner in exterior chimneys or when a brick chimney has no clay liner at all. The insulation will keep the flue gases warm to prevent condensation. Also refer to the equipment

manufacturer's instructions for their recommendations. Insul-Liner can be substituted for B-Vent when relining a masonry chimney.

Insul-Liner is insulated at the factory and protected with an outer aluminum jacket. This eliminates the time needed to insulate on the jobsite and prevents damage to the insulation during installation. Simply remove from the box and install.



Insul-Liner Kit

- Insulated Aluminum Liner
- Chimney Flashing
- Rain Cap
- Mortar Collar
- 3 Screws

Part # 02GIAKXX ___Dia. ___Lgth.
Available in 3" - 8" Diameters
20' Lengths.



Insul-Liner Gas Fireplace Kit

Kit Includes:

- Insulated Aluminum Liner
- Chimney Flashing
- Rain Cap
- Fireplace Connector
- 3 Screws

Part # 02GBAFK ___Dia. ___Lgth.
Available in 4", 5", 6" Diameters
20' Lengths.

Stainless Steel

Oil Kit

Solid Fuel Kit

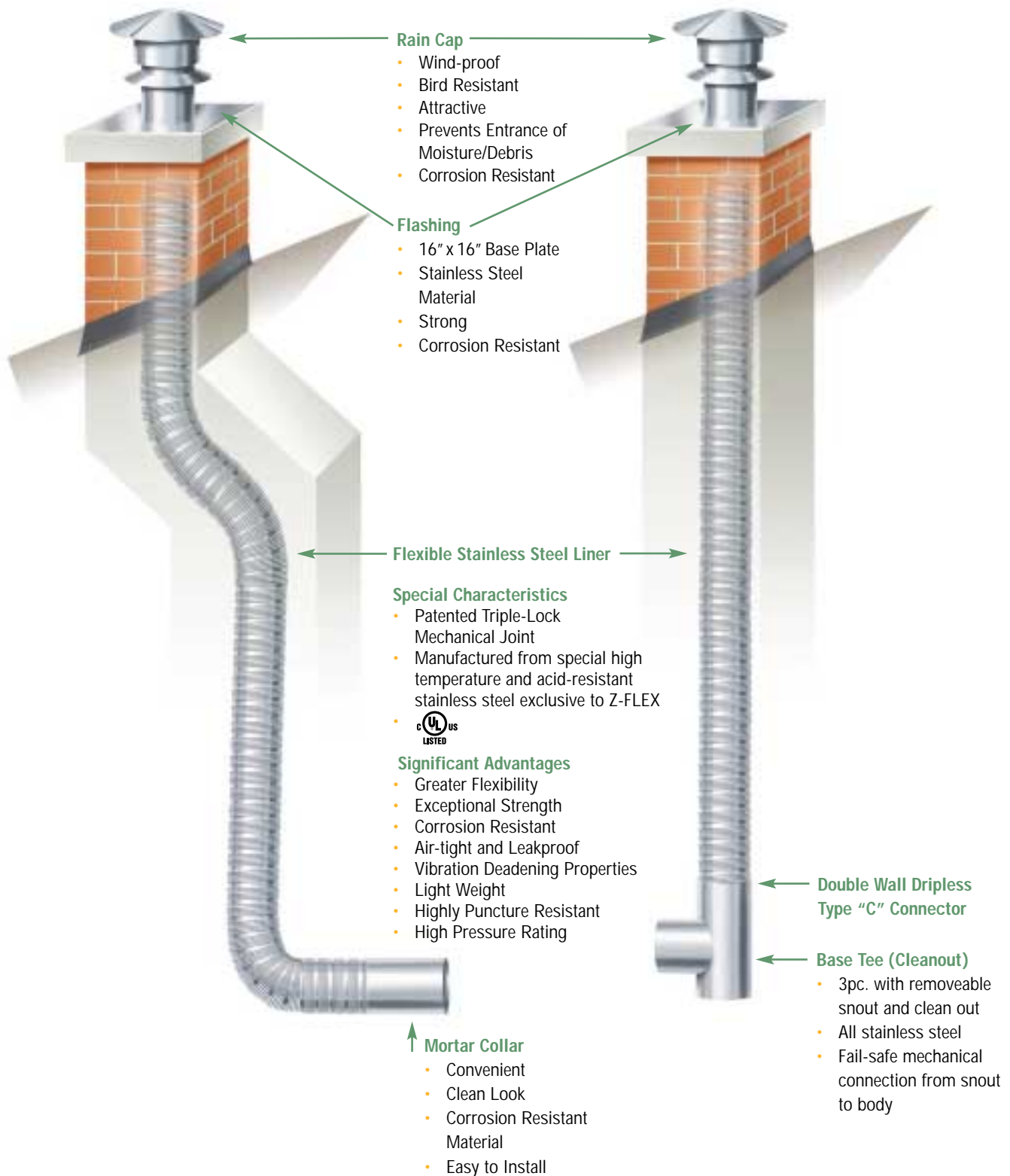

NOTE: Some inspectors may require a cleaning tee on oil fired applications. Consult your local authority having jurisdiction. SS Kits may also be used with natural gas and propane equipment.

Chimney Liner Kits

Z-FLEX Stainless Steel Chimney Liner Kits come complete with everything you need to quickly and easily install a professional venting system. Z-FLEX is engineered to quickly conduct heat, assisting in a natural draft system. It is manufactured from special high temperature and acid resistant stainless steel exclusive to Z-FLEX. Z-FLEX's specially designed 'deep corrugations' provide for greater flexibility and ease of installation. The result is a clearly superior product offering incredible longevity.

When to Z-FLEX a Chimney

- When a masonry chimney has no liner at all
- When damage to existing chimney lining is evident
- When new burner is installed on existing equipment
- When firing rate of existing burner is reduced
- When a new appliance is connected to an existing chimney
- When the existing chimney is oversized relative to heating equipment



Pellet, Oil & Gas Kit

Kit Includes:

- Stainless Steel Liner
- Chimney Flashing
- Rain Cap
- Mortar Collar
- Top Support

Part # 20ILKIT ___Dia. ___Lgth.
Available in 3" - 24" Diameters
Lengths to 50'.



Solid Fuel Kit*

Kit Includes:

- Stainless Steel Liner
- Chimney Flashing
- Rain Cap
- Top Support
- Stacking Tee
- C-Connector

Part # 22FKIT ___Dia. ___Lgth.
Available in 3" - 24" Diameters
Lengths to 50'.

*Insulating Blanket Kit must be installed for a woodburning application (U.S. only)

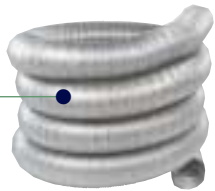

Flexible S/S Round

Part # 2ZLSSXX ___Dia. ___Lgth.
Part # 2ZL294C ___Dia. ___Lgth.
Available in 2", 3", 4", 5", 6", 7", 8", 9", 10" Diameters 2'-24" Lengths in multiples of 5'.



Double Wall Dripless Type "C" Connector

Part # 2CNNTAC ___Dia.
Available in 2", 3", 4", 5", 6", 7", 8", 10" Diameters - Used to mate Z-FLEX Liner to the T-Section, stove-pipe or when going through a fireplace adapter.



3-Piece 45° Adjustable Elbow

Part # 2RE45XX ___Dia.
Available in 2", 3", 4", 5", 6", 7", 8", 10" Diameters.



4-Piece 90° Adjustable Elbow

Part # 2RE90XX ___Dia.
Available in 2", 3", 4", 5", 6", 7", 8", 10" Diameters.

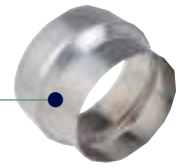

Reducer/Incraser

Reducer Part # 2RD___(dia)R___(dia)X
Incraser Part # 2IN___(dia)I___(dia)X
Available in 3"-4", 4"-5", 5"-6", 6"-7", 6"-8", 7"-8", 8"-10" Diameters.

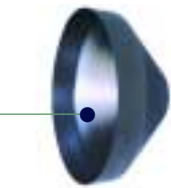

Nose Cone

Part # 2NCXXX ___Dia.
Available in 2", 3", 4", 5", 6", 7", 8", 10" Diameters
To attach to liner, attach rope to cone and pull rope down chimney.

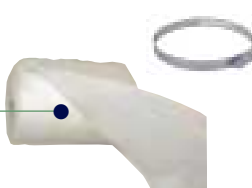

Insulating Blanket w/Wrap & Gear Clamps

Part # 2INSKIT ___Dia.
Includes 2 gear clamps per 5" section.



Stacking Tee w/Cap

Part # 2ZRBTX ___Dia.
Available in 2", 3", 4", 5", 6", 7", 8", 10" Diameters. Note: Z-FLEX Tees are designed to be used with both the Flex and Rigid Lining Systems. Use Type "C" Connector to attach Flex to Tee section.

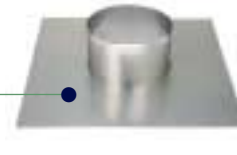

Stainless Steel Chimney Flashing

Starter Collar 16" x 16" Base
Part # 2ZSCSXX ___Dia.
Available in 3", 4", 5", 6", 7", 8", 9", 10" Diameters.



Storm Collar

Part # 2GAC ___Dia.
Available in 2", 3", 4", 5", 6", 7", 8", 9", 10" Diameters
To be used as a rain guard.



Stainless Steel Locking Bands

Part # 2ZRLBXX ___Dia.
Available in 3", 4", 5", 6", 7", 8", 10" Diameters.

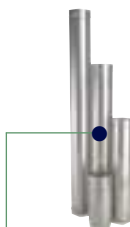

Stainless Steel Rigid Liner

Part # 2ZR321X ___Dia. ___Lgth.
Available in 3", 4", 5", 6", 7", 8", 9", 10" Diameters.

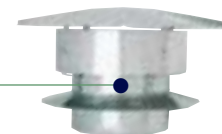

Rain Cap

Part # 2RNCAPS ___Dia.
Available in 3", 4", 5", 6", 7", 8", 10" Diameters.

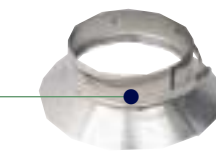

Top Support

Part # 2ZTSXXX ___Dia.
Available in 3", 4", 5", 6", 7", 8", 10" Diameters.



Flexible Gas Vent Connector System

Insul-Vent™ is a double-wall insulated vent connector. Insul-Vent is designed to make insulated connections between appliance and common vent (i.e. B-Vent, masonry chimney, or Z-FLEX chimney liner products), easy and economical. Simply cut to desired length and attach quick-connect ends. No drilling or screwing is required. Plus it eliminates costly elbows and accessories.

Single-Vent™ is a single wall flexible vent connector. Single-Vent, like Insul-Vent, is designed to make difficult installations easy and economical. It replaces rigid single pipe as a vent connector. Both products, like all our other flexible products, are manufactured with our patented triple lock seam. Insul-Vent and Single-Vent are UL listed.



Insul-Vent™

Double Wall Insulated Vent Connector Kit

Kit Includes:

- Length of Double Wall Flex
- Appliance Connector
- Universal Connector

Part # 2ZIKXXX ___Dia. ___Lgth.
Available in 3", 4", 5", 6", 7", 8" Diameters
Available in lengths to 20'.

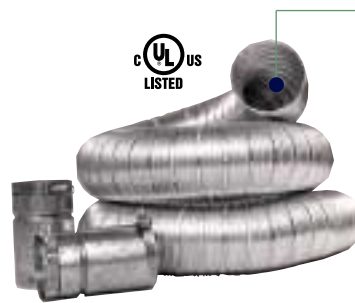

Single-Vent™

Single Wall Vent Connector Kit

Kit Includes:

- Length of Single Wall Flex
- Appliance Connector
- Universal Connector

Part # 2SVKXXX ___Dia. ___Lgth.
Available in 3", 4", 5", 6", 7", 8" Diameters
Available in lengths to 20'.



Insul-Vent Universal Connector

Part # 2IVUCXX ___Dia.
The universal connectors fit any type of single wall pipe, any Type B-Vent or Z-FLEX Chimney Liner.



Insul-Vent Appliance Connector

Part # 2ZICPRP ___Dia.



Additional Length of Insul-Vent

Part # 2INSGAC ___Dia. ___Lgth.
Available in 3", 4", 5", 6", 7", 8" Diameters
Available in lengths to 20'.



Single-Vent Universal Connector

Part # 2SVUCXX ___Dia.
The universal connectors fit any type of single wall pipe, any Type B-Vent or Z-FLEX Chimney Liner.



Single-Vent Appliance Connector

Part # 2ZSCPRP ___Dia.

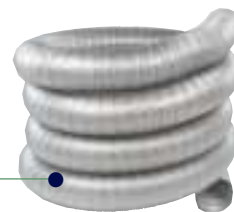

Additional Length of Single-Vent

Part # 2GAXXXX ___Dia. ___Lgth.
Available in 3", 4", 5", 6", 7", 8" Diameters
Available in lengths to 20'.

TYPICAL APPLICATION

- No drilling or screwing required
- No costly elbows
- Cut to length on site
- 1" clearance to combustibles



Flexible Oil Vent Connector System

Oil-Vent™ double-wall insulated vent connector is designed to make insulated connections between appliance and common vent (i.e. L-Vent, masonry chimney, or Z-FLEX chimney liner products), easy and economical. Simply cut to desired length and attach quick-connect ends. No drilling or screwing is required. Plus it eliminates costly elbows and accessories. Equivalent to Type L.

Oil-Vent™ single wall flexible vent connector is designed to make difficult installations easy and economical. It replaces rigid single pipe as a vent connector.

Both products, like all our other flexible products, are manufactured with our patented triple lock seam. Double-Wall and Single-Wall Oil-Vent are UL listed and offer 1" clearance to combustibles.



Oil-Vent™ Double Wall Insulated Vent Connector Kit

Kit Includes:

- Length of Double Wall
- Appliance Connector
- Universal Connector

Part # 20VIKIT ___Dia. ___Lgth.
Available in 3", 4", 5", 6", 7",
8" Diameters
Available in lengths to 20'.

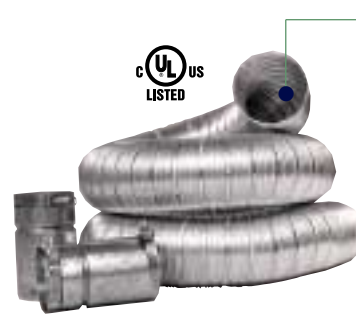

Oil-Vent™ Single Wall Vent Connector Kit

Kit Includes:

- Length of Single Wall
- Appliance Connector
- Universal Connector

Part # 20VSKIT ___Dia. ___Lgth.
Available in 3", 4", 5", 6", 7",
8" Diameters
Available in lengths to 20'.

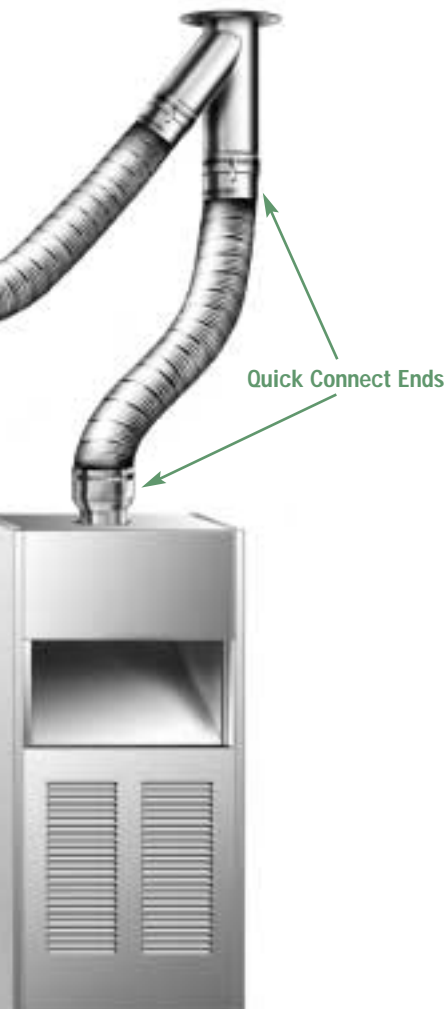

Oil-Vent Double Wall Universal Connector

Part # 20VIUCX ___Dia.
*The universal connectors fit any type
of single wall pipe, any Type L-Vent or
Z-FLEX Chimney Liner.*



Oil-Vent Double Wall Appliance Connector

Part # 20VIACX ___Dia.



Additional Length of Oil-Vent Double Wall

Part # 20ILVENT ___Dia. ___Lgth.
Available in 3", 4", 5", 6", 7",
8" Diameters
Available in lengths to 20'.



Oil-Vent Single Wall Universal Connector

Part # 20VSWUC ___Dia.
*The universal connectors fit any type
of single wall pipe, any Type L-Vent or
Z-FLEX Chimney Liner.*



Oil-Vent Single Wall Appliance Connector

Part # 20VSWAC ___Dia.



Additional Length of Oil-Vent Single Wall

Part # 2ZLSSXX ___Dia. ___Lgth.
Available in 3", 4", 5", 6", 7",
8" Diameters
Available in lengths to 20'.

Z-Vent III™



Special Gas Vent for Category II, III, IV Heating Equipment

Connects in a Snap!

- Simple gasketed connection – no sealant needed*
- Features the highest pressure rating in the industry
- The only metallic special gas vent you can cut to length on site
- New fusion welded pipe seams for a smoother finish and better fit
- 1" clearance to combustibles – can be installed where clearances are minimal

* Patent Pending



GAS VENT



*The lengths of pipe may be cut on non-expanded end using aviation snips or a hacksaw (24 tpi). The cut end must be filed or sanded smooth before joining.

Features:

- Gasketed connections
- The highest pressure rating in the industry
- Fusion welded pipe seams
- The only metallic special gas vent that can be cut to length on site
- 1" clearance to combustibles

Benefits:

- No sealant required – No cure time, no call backs
- More than 3 times the industry standard
- Provides an air-tight seam, smooth finish and a better fit
- Being able to cut the product in the field will save you time and money. Pipe available from 6" thru 10'
- Can be installed with minimum clearance to combustibles

Z-Vent is manufactured using AL29-4C® advanced ferritic stainless steel** with unmatched corrosion resistance for use with condensing furnaces and boilers. Z-Vent was developed in the early 1980's and has thousands of field installations to date. Z-Vent is now manufactured utilizing a fail-safe gasket connection. No sealant is required.

Z-Vent is suitable for use with boilers, high efficiency furnaces, pool heaters, unit heaters and water heaters.

See website for list of equipment



Typical Installations:*

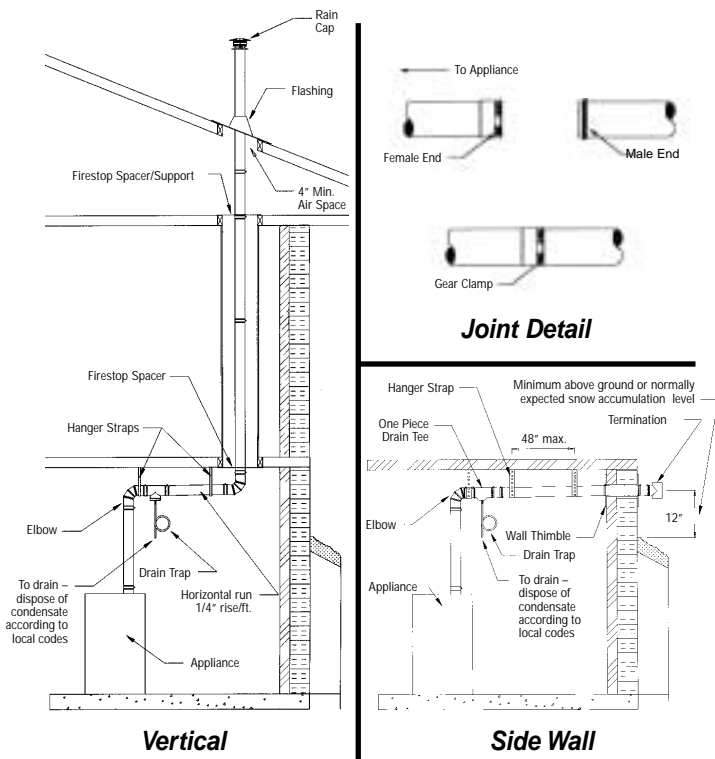

HORIZONTAL DRAINPIPE

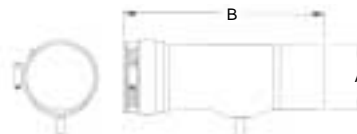

Catalogue No.	Size	A	B
2SVEDWC	3"	3"	8.5"
2SVEDWC	4"	4"	10.5"

PIPE*

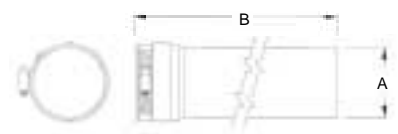

Catalogue No.	Size	A
2SVEPWC03	3"	3"
2SVEPWC04	4"	4"

45 DEG. ELBOW

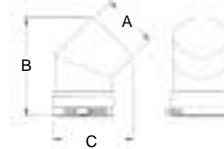

Catalogue No.	Size	A	B	C
2SVEEWC0345	3"	3"	8.25"	5.5"
2SVEEWC0445	4"	4"	7"	5.7"

90 DEG. ELBOW

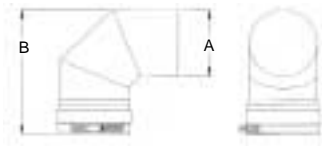

Catalogue No.	Size	A	B
2SVEEWC0390	3"	3"	8.25"
2SVEEWC0490	4"	4"	7.2"

VERTICAL DRAIN/TEE

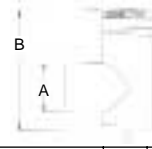

Catalogue No.	Size	A	B
2SVEVWC03	3"	3"	7.5"
2SVEVWC04	4"	4"	7.5"

TERMINATION

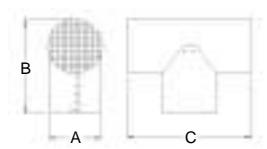

Catalogue No.	Size	A	B	C
2SVSTTX03	3"	3"	6"	6.25"
2SVSTTX04	4"	4"	7"	9.25"

*All drawings are for illustrative purposes only. Please refer to guide for specific U.L. installation instructions. Always defer to local building codes.
**AL29-4C is a registered trademark of Allegheny Ludlum Steel Corporation

*Pipe lengths available – 6", 1', 2', 3', 4', 5', 8', 10'

Appliance connectors available for most equipment. Please refer to price guide.

All Fuel Oval Liner System



Flexible S/S Oval to Round
Part # 2ZLSSOR ___Dia. ___Lgth.
Available in 6", 7", 8", 10" Diameters
Note: To be used in those areas that are re-sealable in one application. Oval accessories available.



Flexible S/S Full Oval
Part # 2ZLSSOX ___Dia. ___Lgth.
Available in 6", 7", 8", 10" Diameters
Note: Oval accessories available.



Stainless Steel Dripless Type "A" Oval Connector
Part # 2CNNTRA ___Dia.
Available in 6", 7", 8", 10" Diameters
Used to join Z-FLEX Oval Liner to Oval T-Section and Oval to Oval Liner or when going through a fireplace adapter.



Stainless Steel Single Oval Base/Tee
Part # 2ZRBTOX ___Dia.
Available in 5", 7", 8", 10" Diameters.



Oval to Round Adapter
Part # 2ZRORAX ___Dia.
Available in 6", 7", 8", 10" Diameters.



Round to Oval Adapter
Part # 2ZRROAX ___Dia.
Available in 6", 7", 8", 10" Diameters.

Liner Finders

The easy-to-apply solution



Apply the right liner every time with **LINER FINDER™** from Z-FLEX.

Our Gas and Oil Liner Finders make it fast and easy to match the right Z-FLEX product and size to the liner application. The convenient "slide rule" design is simple to use, portable, and foolproof.



U.S.A.
20 Commerce Park North,
Bedford, NH 03110-6911
Tel (603) 669-5136 1-800-654-5600
Fax 1-888-889-3539

CANADA
452 Attwell Drive
Etobicoke, ON M9W 5C3
Tel (416) 679-0045
Fax (416) 679-0051