

# No Utility Bills Inc.

[www.noutilitybills.com](http://www.noutilitybills.com)

Tel: (780)628-4835

#301 Lyall Subdivision, County of Athabasca, AB, Canada

VIEWINGS BY APPOINTMENT ONLY!

## Super Jack Wood & Coal Add-On or Stand Alone Furnace

Jacks operate on a forced draft principle. Put some kindling in, light it with a match, and turn the thermostat up. That turns on the combustion fan to get the wood burning. Then load it up and relax. It's automatic from there. The room thermostat tells the combustion fan to start when it is not warm enough and shuts it off when you're comfortable. A fan control mounted in the sheet metal plenum above the firebox tells the circulating blower when to start and stop. All automatically.

Twenty percent of the air (called secondary air) is directed above the fire to ignite the unburned gases and smoke created by the main fire. The result is high efficiency wood burning.

The firebox is made of 7 gauge steel and with the cylindrical (round) build it is near impossible to split or burn out the steel. They have an extra heavy-duty cast iron grate and are lined with 9-inch high firebrick. They are not to be compared to the lightweights from your local discount store.

Jack furnaces have been made since 1976.

Specifications	
Fuel	Wood & Coal
Btu Range	up to 125,000 output
Heating Capacity	up to 3,000 Sq. Ft.
Fire Box Capacity	5.25 Cu. Ft
Wood Length	24" long
Coal Capacity	lbs
Loading Door	13" x 13"
Burn Time	8 - 10 Hours
Blower Size	(Optional) 1/4 HP
Flue Size	7" With Barometric Damper
*Minimum Chimney	15' @ Sea Level
Supply Plenum Size	20" x 22"
Return Plenum Size	Optional 18" x 8"
Filter Size	*N/A -
Duct Clearance	18" to 3' & 6" to 6' & 1" After
Weight	645 lbs
Depth	34-1/2 inches
Height	47 inches
Width	26-1/4 inches
Testing	

### Available accessories:

- Blower Box & Blower
- Plenum Package



### Standard Features:

- Heavy Duty Cast Iron Grates
- Not to be installed in mobile homes
- Heat Exchanger 29.8sq. ft.
- Secondary Heat Exchanger 15.56 sq. ft.
- Easy Access Ash Pan
- Bypass Damper for Smoke-Free Loading
- Easy Access Clean Outs
- Fan and Limit Control
- Transformer / Relay
- FocusPro 5000 digital thermostat

## Furnace Features - SJ125

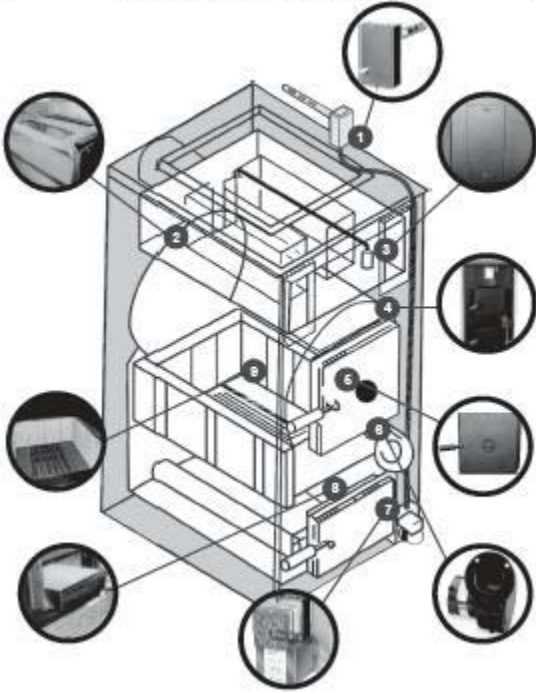

- FAN AND LIMIT CONTROL** - The fan limit control turns the fan on and off in furnace applications. It works off of temperature and also provides a high temperature safety limit.
- SECONDARY HEAT EXCHANGER** - More heat exchanger surface means less heat up the Chimney. Made of 10 gauge steel rectangular tubes, which the heat produced by the furnace, passes through, before entering the chimney.
- EASY ACCESS CLEAN OUTS** - The two clean out plates on the front of the furnace allow easy access to clean the Secondary Heat Exchanger tubes. Keeping the inside of your furnace clean insures high efficiency and helps prevent creosote fires.
- PICTURE FRAME FRONT** - The front and back of the furnace is built of 10 gauge steel and painted with high temperature black paint. The 22 gauge painted side panels are designed to slide onto the flanged steel for easy installation.
- LARGE LOADING FIRE DOOR WITH POSITIVE DOOR LOCK** - This 13" x 13" opening allows for easy loading and larger diameter split logs. The positive door lock ensures that smoke and heat will not escape from the furnace. The round cast iron disc allows secondary air over the flame. It helps burn smoke and unburned gases that leave the flame, thereby increasing efficiency.
- FORCED DRAFT COMBUSTION BLOWER** - This furnace operates on a forced draft principle. When the thermostat is calling for heat, the Draft Blower will turn on to get the fire burning. Draft blower disc must be open.
- HONEYWELL TRANSFORMER / RELAY** - These Honeywell Transformers are the industry standard and made for heating systems. This 24V control circuit step down transformer is designed to power any 24V control system, including thermostats and relays.
- EASY ACCESS ASH PAN** - Designed to allow for easy removal of ashes. Pulls out of furnace, equipped with additional cross bar handle for easy ash disposal.
- HIGH TEMPERATURE FIREBRICK** - 1-1/4 thick Hi-Temperature firebrick surrounds the wood/coal fire. The Big Jack features 90 pounds of firebrick. This firebrick not only protects the steel from the extreme combustion temperature in the firebox, but it also retains a substantial amount of heat after the wood/coal fire burns down.

### HEAVY CAST IRON GRATE

It is imperative that 80 percent of the air for combustion enter the firebox from below a wood/coal grate to insure an efficient and clean burning fire. This grate is made of heavy cast iron that can endure the temperatures of wood and coal fires.

